

# Lab Support Visitor Charter



Dear Visitor,

Please be aware that the user support takes place in addition to our daily research activities at EMBL. We ask you to handle our equipment with care and to respect some rules. If you obtained publishable results from the experiments here please acknowledge the "Visitors lab support at EMBL Grenoble" in your paper. Please provide feedback to [lab\\_support@embl.fr](mailto:lab_support@embl.fr) once you published. This will help us to keep track and to justify the existence of the service.

- Reception hours of the EMBL visitor's lab are Monday to Friday between 9am and 5pm (except on French bank holidays).
- Your EMBL visitor's lab contact person is Estelle Marchal (phone number +334 76 20 7527 )
- A maximum of 2 persons are permitted per experiment in EMBL.
- Respect safety lab rules and procedures at EMBL.
- As of your request, you are allowed to access the following rooms:

**Access to any other rooms or pieces of equipment is strictly prohibited.**

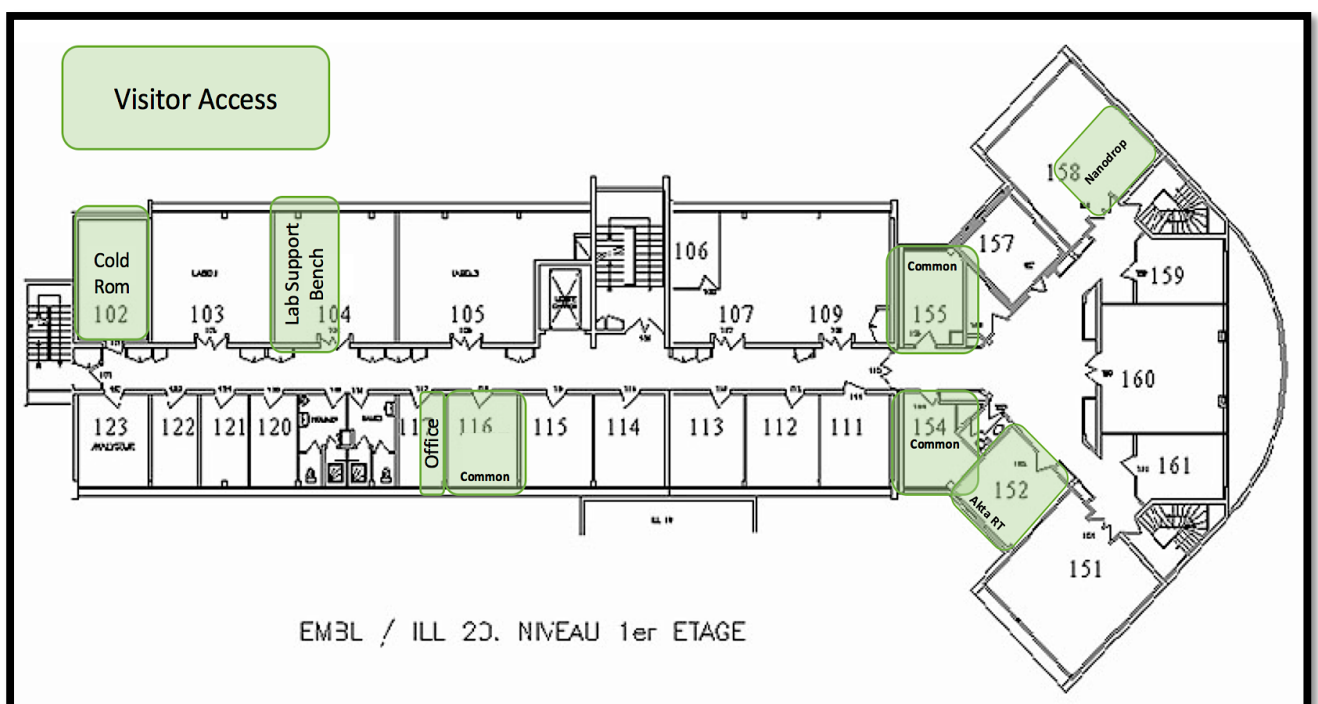

# Lab Support Visitor Charter



- As of your request, you are allowed to access the following equipment, consumables and chemicals:

| List of available equipment booked in advance                                                           | Remarks                                             |
|---------------------------------------------------------------------------------------------------------|-----------------------------------------------------|
| <b>Table Ultracentrifuge Optima TLX</b><br>Rotors: TLA 5.5; SW 60Ti?                                    | Bring your own tubes                                |
| <b>Ultracentrifuge Beckman Optima L-90K</b><br>Rotors: 70 Ti; 45Ti; SW 28; SW 32 Ti; SW 41 Ti; SW 55 Ti | Bring your own tubes                                |
| <b>Centrifuge Beckman Avanti J-20 XP</b><br>Rotors: JA20; JA14; JA25.50; JLAB.1000                      | Bring your own tubes                                |
| <b>Centrifuge Eppendorf 5804 R (14-50mL Falcon)</b>                                                     |                                                     |
| <b>AKTA Pure/Purifier RT and Cold room</b>                                                              |                                                     |
| <b>Sonicator Ultra-Cell</b>                                                                             |                                                     |
| <b>Lyophilizer</b>                                                                                      |                                                     |
| <b>Microfluidizer</b>                                                                                   |                                                     |
| <b>Shakers (16°C-37°C)</b>                                                                              |                                                     |
| List of available equipment                                                                             | Remarks                                             |
| <b>-80°C storage</b>                                                                                    | Limited to the time of the experiment               |
| <b>-20°C storage</b>                                                                                    | Limited to the time of the experiment               |
| <b>Cold room storage</b>                                                                                | Limited to the time of the experiment               |
| <b>Incubators 37°C (for LB agar plate)</b>                                                              |                                                     |
| <b>Nanodrop</b>                                                                                         |                                                     |
| <b>pHmeter</b>                                                                                          |                                                     |
| <b>Filtration Pump</b>                                                                                  |                                                     |
| <b>Vortex</b>                                                                                           |                                                     |
| <b>Agitator</b>                                                                                         |                                                     |
| <b>Pipets P2; P10; P100; P200; P1000</b>                                                                |                                                     |
| <b>Pipet boy</b>                                                                                        |                                                     |
| <b>Scales</b><br>precision 10mg-51g (toxic chemicals) 0.5-620g or kg for 1L bottles                     |                                                     |
| <b>Table centrifuge</b><br>1.5 – 2mL microtubes RT or cold room                                         |                                                     |
| <b>Spatula</b>                                                                                          |                                                     |
| <b>Magnets</b>                                                                                          |                                                     |
| <b>Glassware</b><br>Cylinders; Becher; Bottles                                                          |                                                     |
| <b>Hood for solvent</b>                                                                                 |                                                     |
| <b>Flame</b>                                                                                            | For L1 bacteriological strain                       |
| <b>Spectrophotometer (OD 600nm)</b>                                                                     |                                                     |
| <b>Microwave</b>                                                                                        | Do not heat toxic or solvent (Acetic acid, Ethanol) |
| <b>Heating block 95°C; 55°C; 42°C</b>                                                                   |                                                     |
| List of non available equipment                                                                         |                                                     |
| Casting/ running SDS or agarose gels, bacteriological hood ...                                          |                                                     |

| List of available consumables                                                   | Remarks                 |
|---------------------------------------------------------------------------------|-------------------------|
| <b>Micro tubes</b><br>0.5mL, 1.5mL; 2mL                                         |                         |
| <b>Falcon tubes</b><br>15 and 50mL                                              |                         |
| <b>Tips and sterilized tips</b>                                                 |                         |
| <b>Tape</b>                                                                     |                         |
| <b>Membrane 0.2um to filter solution</b>                                        |                         |
| <b>Filter for syringe</b><br>0.22 and 0.45um                                    |                         |
| <b>Syringes</b><br>1; 2; 5; 10; 20; 50mL                                        |                         |
| <b>Gloves latex; nitrile</b>                                                    |                         |
| <b>Tissue</b>                                                                   |                         |
| <b>Serological pipet</b><br>1; 2; 5; 10; 25mL                                   |                         |
| <b>Plastic bag zip</b>                                                          |                         |
| <b>Needle sharp end not for Akta injection</b>                                  |                         |
| <b>Dry ice</b>                                                                  | Not available every day |
| <b>Gaz for flame</b>                                                            |                         |
| <b>MQ water and distilled</b>                                                   |                         |
| <b>Ice</b>                                                                      |                         |
| <b>pH paper</b>                                                                 |                         |
| <b>Plastic cuvette</b>                                                          |                         |
| <b>Parafilm</b>                                                                 |                         |
| List of non available consumables                                               |                         |
| Columns (SEC, AEX,...); concentrators; filtration units; dialysis membrane .... |                         |

## Chemicals

|        |           |                   |                                        |
|--------|-----------|-------------------|----------------------------------------|
| 101660 | Chemicals | Fisher Scientific | Tampon pH10-500ML                      |
| 101665 | Chemicals | Fisher Scientific | Tampon pH4-500ML                       |
| 101666 | Chemicals | Fisher Scientific | Tampon pH7-500ML                       |
| 101688 | Chemicals | Euromedex France  | Chlorure de sodium -1KG                |
| 101696 | Chemicals | Euromedex France  | Glycerol -1L                           |
| 101698 | Chemicals | Euromedex France  | Guanidine hydrochloride -500G          |
| 101699 | Chemicals | Euromedex France  | Hepes -500G                            |
| 101703 | Chemicals | Euromedex France  | Potassium chloride -1KG                |
| 101739 | Chemicals | Euromedex France  | Tris -1KG                              |
| 101711 | Chemicals | Euromedex France  | Urée -1KG                              |
| 101725 | Chemicals | MP Biomedicals    | DTT -5G                                |
| 101730 | Chemicals | MP Biomedicals    | Sodium phosphate dibasique anhydre -1K |
| 101731 | Chemicals | MP Biomedicals    | Sodium phosphate monobasique -1KG      |
| 101742 | Chemicals | Sigma Aldrich     | Imidazole -500G                        |
| 101688 | Chemicals | Euromedex France  | NaCl -1KG                              |
| 101759 | Chemicals | Sigma Aldrich     | Mes -50G                               |
| 101781 | Chemicals | VWR               | Acide chlorhydrique fumant 37% -1L     |
| 101783 | Chemicals | VWR               | Alcool Ethylique absolu puro -5L       |
| 101794 | Chemicals | VWR               | Sodium hydroxyde en pastilles -1KG     |

# Lab Support Visitor Charter



- Before your departure, do not forget to remove your samples and buffers from the cold room, -20°C, -80°C
- In case of ... (by using the lab phone):

***Please read the following information carefully***  
**WHAT TO DO IN CASE OF...**

| <b>... A MEDICAL EMERGENCY</b>                                                                                                                                                                                                                                                                                                                                                                                                                                                                                                                                                                        | <b>... A FIRE OR TECHNICAL ACCIDENT</b>                                                                                                                                                                                                                                                                                                                                | <b>... A SITE OR BUILDING ALARM</b>                                                                                                                                                                                                                                                                                                                                                                                                                                                                                                                                                                                                                                                                                                                               |
|-------------------------------------------------------------------------------------------------------------------------------------------------------------------------------------------------------------------------------------------------------------------------------------------------------------------------------------------------------------------------------------------------------------------------------------------------------------------------------------------------------------------------------------------------------------------------------------------------------|------------------------------------------------------------------------------------------------------------------------------------------------------------------------------------------------------------------------------------------------------------------------------------------------------------------------------------------------------------------------|-------------------------------------------------------------------------------------------------------------------------------------------------------------------------------------------------------------------------------------------------------------------------------------------------------------------------------------------------------------------------------------------------------------------------------------------------------------------------------------------------------------------------------------------------------------------------------------------------------------------------------------------------------------------------------------------------------------------------------------------------------------------|
| <p><b>Call the Medical Service: 33</b></p> <ul style="list-style-type: none"><li>▶ Give the following details:<ul style="list-style-type: none"><li>- The exact location,</li><li>- The reason for the call,</li><li>- The number of casualties and their condition,</li><li>- The circumstances,</li><li>- Never be the first to hang up.</li></ul></li><li>▶ Contact the nearest First-Aider (photos are posted in the corridors).</li><li>▶ Protect the victim(s) to avoid a secondary accident.</li><li>▶ Never transport an injured person by your own means. Wait for help to arrive.</li></ul> | <p><b>Call the reactor control room: 11 or red telephone (FLS emergency response unit)</b></p> <ul style="list-style-type: none"><li>▶ Fight the fire using the right type of extinguisher.</li><li>▶ If the fire begins to take hold: evacuate calmly and do not use the lifts.</li><li>▶ If there is smoke, stay low: any fresh air is close to the floor.</li></ul> | <p><b>If you hear</b><br/><b>... an alarm inside the building:</b></p> <ul style="list-style-type: none"><li>▶ Make your way calmly to the outside assembly point: do not use the lifts. Please remember: internal building alarms always take precedence over outside sirens.</li></ul> <p><b>... a wavering siren sounding outside:</b></p> <ul style="list-style-type: none"><li>▶ Take cover inside the closest building: close all doors, windows and vents, and listen out for other alarms or loudspeaker instructions.</li><li>▶ If an alarm then sounds inside the building or if you are instructed to do so over the loudspeaker: make your way to the outside assembly point, where you will be given instructions for evacuating the site.</li></ul> |

I have read and understood the above terms and conditions,

Date:

Signature: